



40 Thatch Leach, Chadderton

Offers Over £250,000

🛏️ 3 🚿 1 🚗 2



- Semi Detached
- Open Plan Kitchen Dining
- Popular Location
- Superb Family Home
- Three Bedrooms
- Well Presented Throughout
- Garage and Driveway
- EPC - Rating D



Providing an ideal young family home is this three bedroom semi detached property situated on the ever popular Thatch Leach, situated just off Broadway therefore close to excellent local schools, amenities and transport links. Internally the well presented living space comprises of porch, entrance hallway with useful under stairs storage, lounge, open plan kitchen diner, wc and light and airy summer room. Off the first floor landing there is access to a boarded loft (with power and lighting) via a pull down ladder and there are three bedrooms, two with fitted wardrobes and the master having new fitted wardrobes. Also benefits from a modern shower room. Externally the property overlooks open fields to the front with a gated driveway and low maintenance garden, whilst to the rear is a detached single garage and a garden with artificial grass and Indian stone patio area. The property also benefits from gas central heating and double glazing.

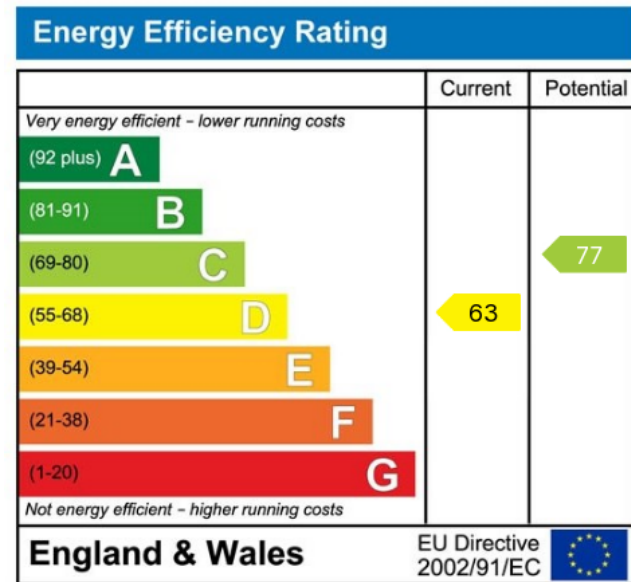
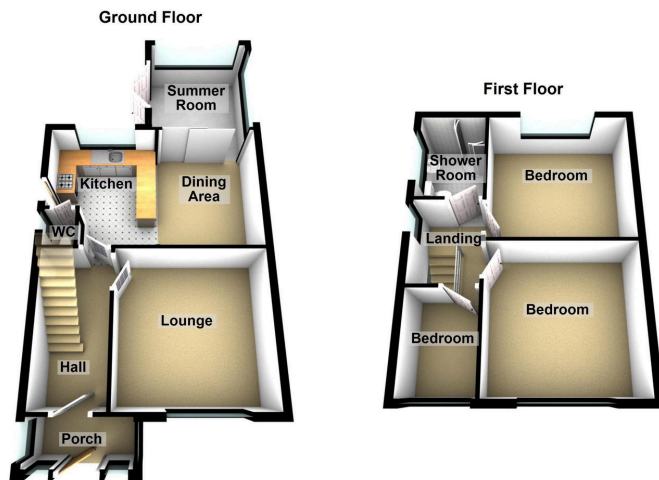

Chadderton Office

509 Middleton Road,
Chadderton, Oldham,
OL9 9SH

chadderton@kirkham-property.co.uk
t: 0161 626 5688